



Concrete Solution Builders & Supply

36 Lourdes Castillo St., Brgy Don Manuel
Quezon City
Tel. Nos. 7417106, 7418702
Fax No. 7425230
email: rasis@concretesolution.com.ph



Building Solutions

PROTECTED MEMBRANE ROOF (PMR)

INSULATION METHOD STATEMENT

A. Introduction

The PMR system places the insulation on top of the membrane, protecting the roofing membrane from extreme temperature changes and physical abuse, resulting in excellent long-term performance and durability.

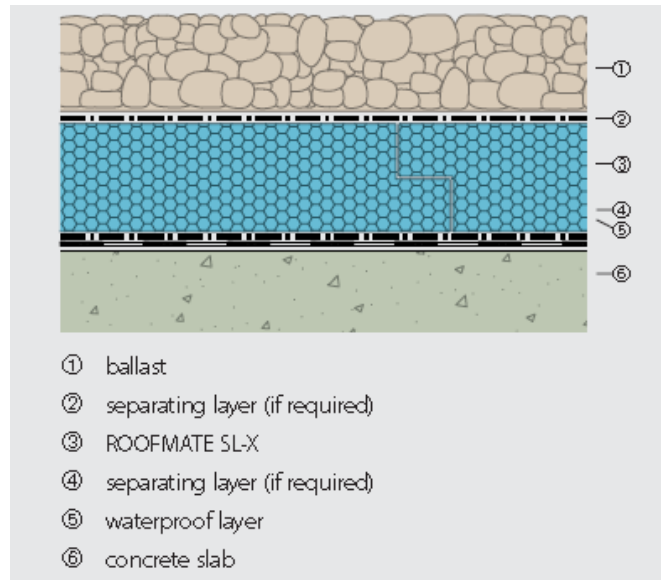

B. Precaution and safety

1. Protect insulation from physical damage.
2. Handle boards carefully.
3. Always wear protective eyewear and gloves.
4. Always store insulation away from direct sunlight.
5. Cover insulation with light-colored opaque tarp or polyethylene film for protection from sunlight.
6. Always check the compatibility with other products that may come in direct contact with the insulation. Preventive care must be taken, such as allowing solvents to evaporate, providing a slip sheet or painting the surface of the insulation with white latex paint.
7. The insulation material should not be exposed to open flames or other ignition sources.



Concrete Solution Builders & Supply

36 Lourdes Castillo St., Brgy Don Manuel
Quezon City
Tel. Nos. 7417106, 7418702
Fax No. 7425230
email: rasis@concretesolution.com.ph



8. Make sure PMR insulations are not left exposed. When ballasts or concrete topping installation is delayed, temporarily cover with light-colored opaque tarp or polyethylene film.
9. To prevent fine sands from being washed under the insulation where they could damage the waterproofing membrane, it is recommended that a filter fabric be used.
10. Use protection boards when barrowing heavy materials over the insulation.



C. Installation notes

1. Do not lay insulation until roof is cleared of other contractors.
2. Plan the installation sequence and the layout. Set out to minimize cutting and avoid small cut pieces at perimeters and penetrations.
3. Clean off all dirt and debris from the concrete base.
4. If required, install a slip or separation sheet over the membrane if the membrane is coal tar or Type 1 or 2 asphalt, or if required by membrane manufacturer. Overlap all slip or separation sheets by 200 – 300-mm.
5. Loose lay boards, tightly butted or shiplapped to a brick pattern, cut cleanly to fit closely around projections, upstands, rainwater outlets, etc.



Concrete Solution Builders & Supply

36 Lourdes Castillo St., Brgy Don Manuel
Quezon City
Tel. Nos. 7417106, 7418702
Fax No. 7425230
email: rasis@concretesolution.com.ph

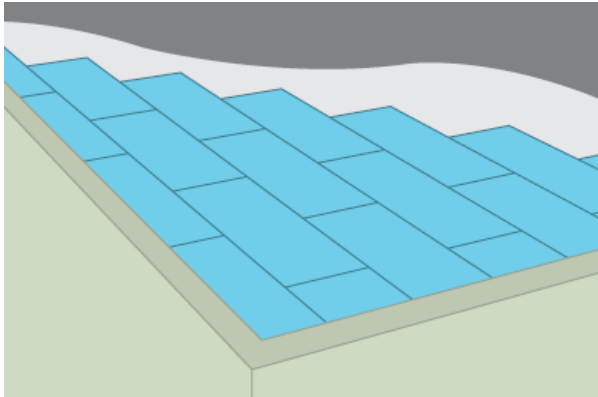

6. Butt boards tightly together, staggering or offset end joints. The recommended stagger or offset between each board is 2-feet.
7. Fit around protrusions and obstructions with a maximum 3/4-inch gap. Cut boards with a sharp knife or fine toothed saw.
8. On completion of laying ensure boards are in good condition, with no springing, flexing, or rocking.

9. If required, lay a filter layer with 150-mm overlaps
10. Secure boards against wind uplift as soon as practicable.
11. It is recommended that ballasts or mortar topping is installed immediately after completely laying the insulation.

D. Other notes

The information and data contained in this method statement do not represent exact sales specifications. The features of the products mentioned may vary. The information contained in this document has been provided in good faith, however it does not imply any liability, guarantee, or assurance of product performance.